

GP Component

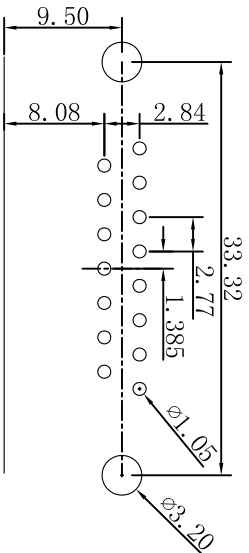

PCB layout

Specification Type (1:2)

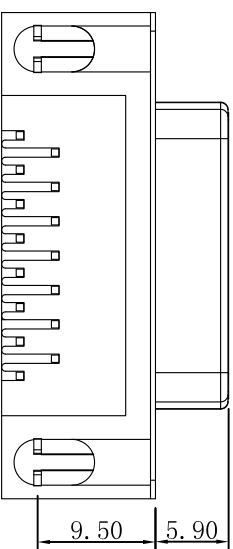
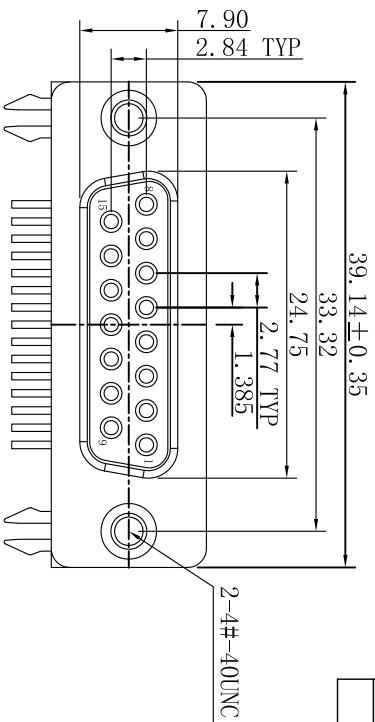
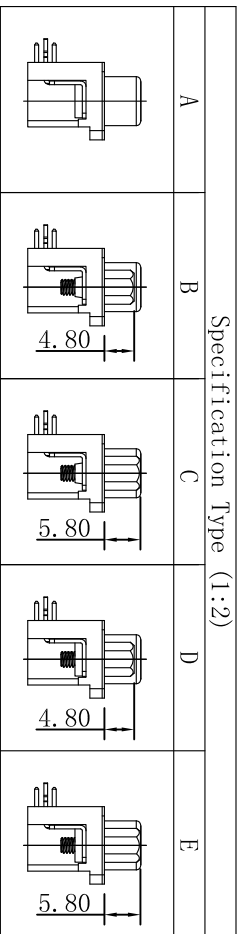

REV.	ECN NO.	LOCATIONS	DESCRIPTION	DATE	DESIGN
AO			原始版本(INITIAL EDITION)	2020.12.16	m t

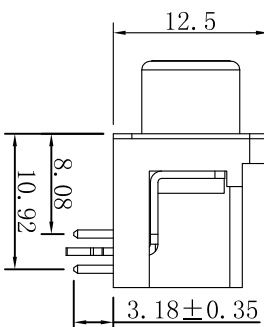

CHARACTERISTICS:

1. RATED VOLTAGE: 250V AC CD
2. RATED CURRENT: 3.0AMP
3. CONTACT RESISTANCE: 30mΩ Max.
4. INSULATION RESISTANCE: 1000 MΩ MIN. 500V DC
5. Electric Pressure: Keeping 60 second in AC 500V/1mA
6. Operating temperature: -55°C~105°C
7. INSERTION/EXTRACTION FORCE PER CONTACT: 5.0Kg Max
0.45Kg Min.

01.DR0815 F X XXX XX A XXX

PIN Poles	15:15PIN				
M/F Differentiates	M=Male F=Female				
Hsg Color	1=Black 3=Blue 2=White 4=Green 5=Yellow 6=Purple				
Plating	G00:Gold flash G01:Gold 1U" G03:Gold 3U" Gxx:Gold XXU"				
	B00:Bright sn B01:Bright sn 1U" B03:Bright sn 3U" Bxx:Bright sn XXU"				
	M00:Matte sn M01:Matte sn 1U" M03:Matte sn 3U" Mxx:Matte sn XXU"				
		Water Code			
		Specification Type			
		Hsg Material			
		H1=PB1 HF H4=PA66 HF I0=PB1 I3=PA66			
		H2=PA6T HF H5=LCF I1=PA6T I4=PA46			
		H3=PA9T HF I2=PA9T			

	DESIGN:	2020.12.16		东莞市跃展精密连接器有限公司 Dongguan YueZhan Precision Connectors Co.,Ltd
	CHECKED:	2020.12.16		
TOLERANCE:	X.X ±0.35 X.XX ±0.25 X.XXX ±0.15 Angle ±3.0°	APPROVED:	2020.12.16	
SCALE:1:1	SIZE:A4	SHEET NO.	01 OF 01	